



## IC Series

### Constant Pressure Inverter Control System



**Walrus America Inc**

**ISO 9001 Certified**

# **TPHIC** Series Constant Pressure Inverter Control System

| <b>Explanation</b>                     | <b>Page</b> |
|--|-------------|
| Applications                           | 3           |
| Suitable Liquids                       | 3           |
| Application Conditions                 | 3           |
| Product Features                       | 3           |
| Model Code                             | 3           |
| Accessories                            | 3           |
| Performance Curves - Simplex           | 4           |
| Performance Curves - Duplex            | 4           |
| <b>Specifications &amp; Dimensions</b> |             |
| TPH 2T/4T IC                           | 5           |
| TPH 8T/12T IC                          | 6           |
| TPH 25T/50T IC                         | 7           |
| TPH 2T/4T IC x2                        | 8           |
| TPH 8T/12T IC x2                       | 9           |
| TPH 25T IC x2                          | 10          |
| TPH 50T IC x2                          | 11          |

Walrus TPHIC series is a system that combines pump and inverter control panel to provide a constant supply of pressurized water. It is available in simplex and duplex pre-engineered design with standard and optional features.

### Applications:

Boost a constant water pressure for apartment buildings, motels, factories, houses, irrigation systems, water filtration systems, HVAC systems, etc.

### Suitable Liquids:

Potable water or other clean, thin or non-aggressive liquids.

### Application Conditions:

Ambient temperature: Max. +104°F (+40°C)

Liquid temperature: +39°F ~ +104°F (+4°C ~+40°C)

Inlet pressure: Lower than the constant pressure setting limit (see page 5~11)

### Product Features:

The pump will start smoothly when the tap is open and will continue to run when water is in use. It will stop when system is in max pressure and the water flow is stopped. The pressure is transmitted by pressure sensor for normal auto on-off operation. The factory has preset the pressure according to each rating and it is adjustable by changing the program in the inverter controller. Pump will always provide the constant pressure; although the motor speed will be varied by the different operating flow rate.

### Dry run protection:

The pump will automatically shut off when it is in dry run. When the discharge cannot reach the set pressure, or the liquid temperature exceeds 131°F (55°C), the pump will stop. It will resume operation when the water supply is back up or the liquid temperature drops to below 104°F (40°C).

### Pressure compensation for pipe leak:

The pump will compensate the pressure loss due to the leak in the system. When the system leak has dried out the water in the pressure tank, the pump will automatically start to fill up the tank.

### Duplex system operations:

The lead pump shall run continuously to maintain system pressure. When the lead pump is unable to maintain system pressure the lag pump will be called on and will operate in parallel with the lead pump. When one pump can handle the system demand the controls will shut down the lag pump. Pump alternation is accomplished with a 24-hour time clock.

### Model Code:

Example:

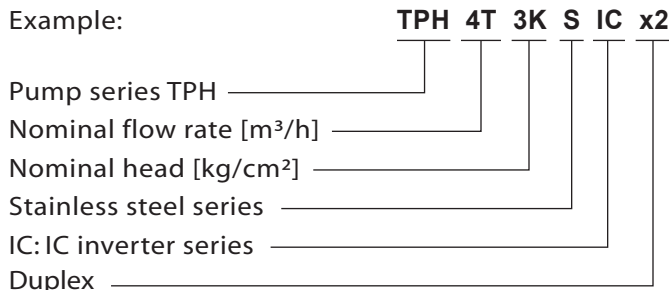

### Accessories:

Subject to added cost, Walrus is able to supply the following accessories:

1. The inlet header for Duplex systems.
2. The shut off valves for inlet and outlet.

# TPHIC Series Constant Pressure Inverter Control System

## Performance Curves - Simplex

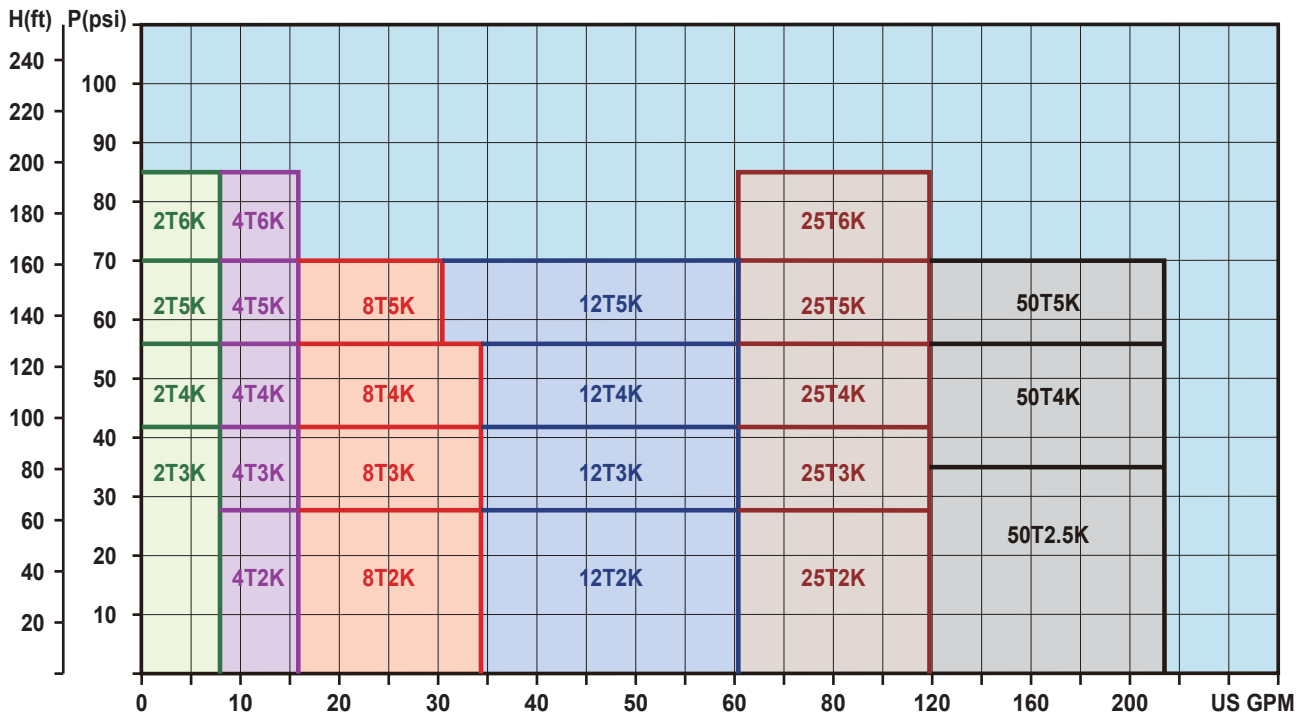

## Performance Curves - Duplex

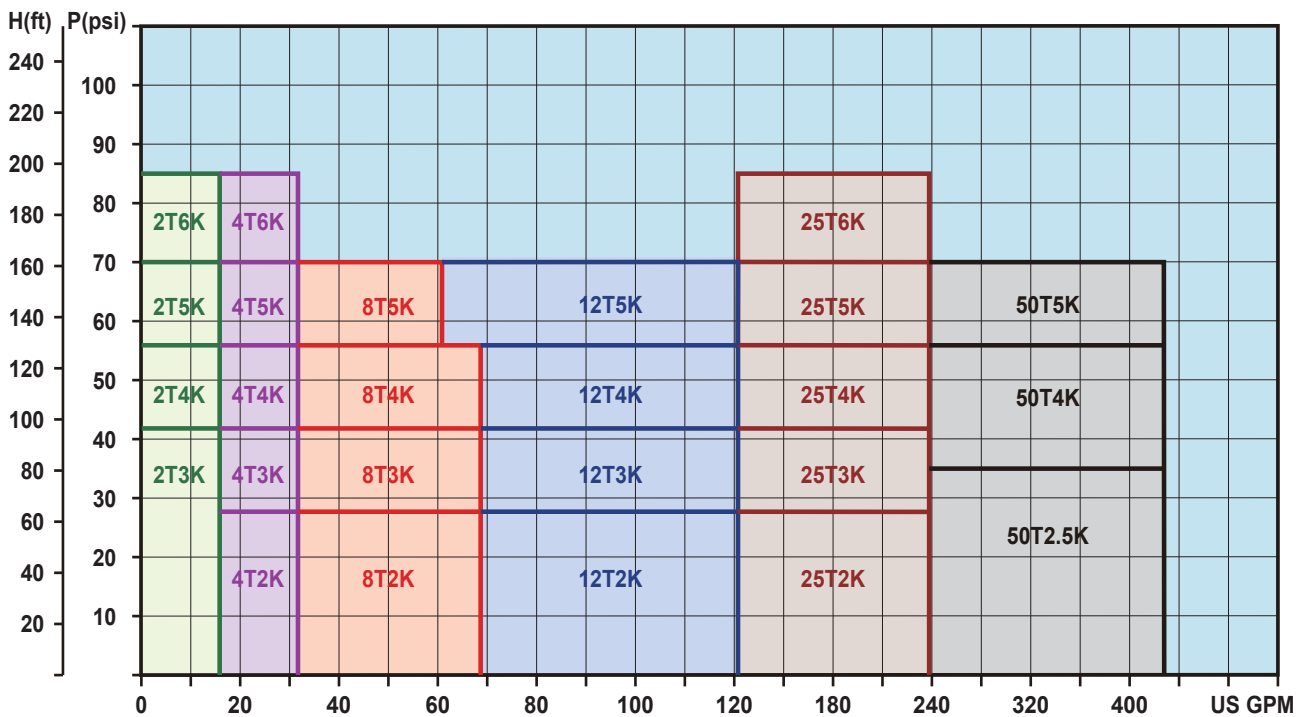

## Specifications - Simplex

| Model        | Inverter Controller |                             | No-Fuse Breaker (A) | Pre-set Pressure (PSI) | Inlet (NPT) | Outlet (NPT) | Nominal Set Head (ft) | Nominal set Flow (GPM) |
|--------------|---------------------|-----------------------------|---------------------|------------------------|-------------|--------------|-----------------------|------------------------|
|              | Output Power (HP)   | Voltage (V)                 |                     |                        |             |              |                       |                        |
| TPH2T3K(S)IC | 1                   | 1Ø 115V / 1Ø 230V / 3Ø 230V | 15/ 10/ 5           | 42                     | 1"          | 1"           | 98                    | 8                      |
|              |                     | 3Ø 460V                     | 5                   |                        |             |              |                       |                        |
| TPH2T4K(S)IC | 1                   | 1Ø 115V / 1Ø 230V / 3Ø 230V | 15/ 10/ 5           | 56                     | 1"          | 1"           | 130                   | 8                      |
|              |                     | 3Ø 460V                     | 5                   |                        |             |              |                       |                        |
| TPH2T5K(S)IC | 1                   | 1Ø 115V / 1Ø 230V / 3Ø 230V | 30/ 15/ 10          | 70                     | 1"          | 1"           | 160                   | 8                      |
|              |                     | 3Ø 460V                     | 5                   |                        |             |              |                       |                        |
| TPH2T6K(S)IC | 1                   | 1Ø 115V / 1Ø 230V / 3Ø 230V | 30/ 15/ 10          | 85                     | 1"          | 1"           | 196                   | 8                      |
|              |                     | 3Ø 460V                     | 5                   |                        |             |              |                       |                        |
| TPH4T2K(S)IC | 1                   | 1Ø 115V / 1Ø 230V / 3Ø 230V | 15/ 10/ 5           | 28                     | 1½"         | 1½"          | 65                    | 16                     |
|              |                     | 3Ø 460V                     | 5                   |                        |             |              |                       |                        |
| TPH4T3K(S)IC | 1                   | 1Ø 115V / 1Ø 230V / 3Ø 230V | 30/ 15/ 10          | 42                     | 1½"         | 1½"          | 98                    | 16                     |
|              |                     | 3Ø 460V                     | 5                   |                        |             |              |                       |                        |
| TPH4T4K(S)IC | 2                   | 1Ø 230V / 3Ø 230V           | 15/ 10              | 56                     | 1½"         | 1½"          | 130                   | 16                     |
|              |                     | 3Ø 460V                     | 5                   |                        |             |              |                       |                        |
| TPH4T5K(S)IC | 2                   | 1Ø 230V / 3Ø 230V           | 20/ 15              | 70                     | 1½"         | 1½"          | 160                   | 16                     |
|              |                     | 3Ø 460V                     | 10                  |                        |             |              |                       |                        |
| TPH4T6K(S)IC | 2                   | 1Ø 230V / 3Ø 230V           | 20/ 20              | 85                     | 1½"         | 1½"          | 196                   | 16                     |
|              |                     | 3Ø 460V                     | 10                  |                        |             |              |                       |                        |

\*\* (S): Stainless steel series

## Dimensions ( in. )

• Fig. 1 TPH2T / 4T - IC

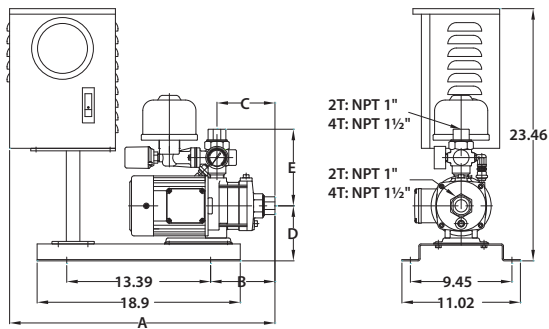

| Model     | A     | B     | C    | D    | E    | Pressure tank (gal) | Fig. | N.W. (lb) |
|-----------|-------|-------|------|------|------|---------------------|------|-----------|
| TPH2T3KIC | 21.34 | 5.20  | 4.61 | 5.12 | 7.24 | 0.2                 | 1    | 52.7      |
| TPH2T4KIC | 22.05 | 5.91  | 5.31 | 5.12 | 7.24 | 0.2                 | 1    | 52.9      |
| TPH2T5KIC | 22.76 | 6.61  | 6.02 | 5.12 | 7.24 | 0.2                 | 1    | 56.2      |
| TPH2T6KIC | 23.46 | 7.32  | 6.73 | 5.12 | 7.24 | 0.2                 | 1    | 56.4      |
| TPH4T2KIC | 22.13 | 5.98  | 5.39 | 5.12 | 7.24 | 0.2                 | 1    | 50.9      |
| TPH4T3KIC | 23.15 | 7.01  | 6.42 | 5.12 | 7.24 | 0.2                 | 1    | 54.5      |
| TPH4T4KIC | 24.21 | 8.07  | 7.48 | 5.12 | 7.24 | 0.2                 | 1    | 58.2      |
| TPH4T5KIC | 25.28 | 9.13  | 8.54 | 5.12 | 7.24 | 0.2                 | 1    | 58.4      |
| TPH4T6KIC | 26.38 | 10.24 | 9.65 | 5.12 | 7.24 | 0.2                 | 1    | 62.6      |

# TPH 8T/12T IC

## Specifications - Simplex

| Model         | Inverter Controller |                             | No-Fuse Breaker (A) | Pre-set Pressure (PSI) | Inlet (NPT) | Outlet (NPT) | Nominal Set Head (ft) | Nominal set Flow (GPM) |
|---------------|---------------------|-----------------------------|---------------------|------------------------|-------------|--------------|-----------------------|------------------------|
|               | Output Power (HP)   | Voltage (V)                 |                     |                        |             |              |                       |                        |
| TPH 8T2K(S)IC | 1                   | 1Ø 115V / 1Ø 230V / 3Ø 230V | 30/ 15/ 10          | 28                     | 2"          | 2"           | 65                    | 34                     |
|               |                     | 3Ø 460V                     | 5                   |                        |             |              |                       |                        |
| TPH8T3K(S)IC  | 2                   | 1Ø 230V / 3Ø 230V           | 20/ 15              | 42                     | 2"          | 2"           | 98                    | 34                     |
|               |                     | 3Ø 460V                     | 10                  |                        |             |              |                       |                        |
| TPH8T4K(S)IC  | 3                   | 1Ø 230V / 3Ø 230V           | 30/ 15              | 56                     | 2"          | 2"           | 130                   | 34                     |
|               |                     | 3Ø 460V                     | 10                  |                        |             |              |                       |                        |
| TPH8T5K(S)IC  | 3                   | 1Ø 230V / 3Ø 230V           | 30/ 15              | 70                     | 2"          | 2"           | 160                   | 30                     |
|               |                     | 3Ø 460V                     | 10                  |                        |             |              |                       |                        |
| TPH12T2K(S)IC | 2                   | 1Ø 230V / 3Ø 230V           | 10/ 5               | 28                     | 2"          | 2"           | 65                    | 60                     |
|               |                     | 3Ø 460V                     | 5                   |                        |             |              |                       |                        |
| TPH12T3K(S)IC | 3                   | 1Ø 230V / 3Ø 230V           | 30/ 15              | 42                     | 2"          | 2"           | 98                    | 60                     |
|               |                     | 3Ø 460V                     | 10                  |                        |             |              |                       |                        |
| TPH12T4K(S)IC | 5                   | 3Ø 230V                     | 20                  | 56                     | 2"          | 2"           | 130                   | 60                     |
|               |                     | 3Ø 460V                     | 10                  |                        |             |              |                       |                        |
| TPH12T5K(S)IC | 5                   | 3Ø 230V                     | 30                  | 70                     | 2"          | 2"           | 160                   | 60                     |
|               |                     | 3Ø 460V                     | 15                  |                        |             |              |                       |                        |

\*\* (S): Stainless steel series

## Dimensions ( in.)

• Fig. 2 TPH8T /12T - IC

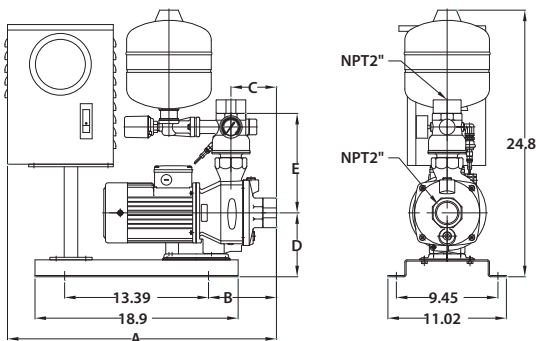

| Model      | A     | B    | C    | D    | E     | Pressure tank (gal) | Fig. | N.W. (lb) |
|------------|-------|------|------|------|-------|---------------------|------|-----------|
| TPH8T2KIC  | 22.44 | 6.30 | 4.21 | 5.91 | 10.47 | 1.0                 | 2    | 70.1      |
| TPH8T3KIC  | 23.70 | 7.56 | 5.47 | 5.91 | 10.47 | 1.0                 | 2    | 72.8      |
| TPH8T4KIC  | 23.70 | 7.56 | 5.47 | 5.91 | 10.47 | 1.0                 | 2    | 84.6      |
| TPH8T5KIC  | 25.04 | 8.90 | 6.81 | 5.91 | 10.47 | 1.0                 | 2    | 84.8      |
| TPH12T2KIC | 22.44 | 6.30 | 4.21 | 5.91 | 10.47 | 1.0                 | 2    | 72.7      |
| TPH12T3KIC | 23.70 | 7.56 | 5.47 | 5.91 | 10.47 | 1.0                 | 2    | 84.6      |
| TPH12T4KIC | 23.70 | 7.56 | 5.47 | 5.91 | 10.47 | 1.0                 | 2    | 108.4     |
| TPH12T5KIC | 27.40 | 8.90 | 6.81 | 5.91 | 10.47 | 1.0                 | 2    | 123.5     |

## Specifications - Simplex

| Model           | Inverter Controller |             | No-Fuse Breaker (A) | Pre-set Pressure (PSI) | Inlet (NPT) | Outlet (NPT) | Nominal Set Head (ft) | Nominal set Flow (GPM) |
|-----------------|---------------------|-------------|---------------------|------------------------|-------------|--------------|-----------------------|------------------------|
|                 | Output Power (HP)   | Voltage (V) |                     |                        |             |              |                       |                        |
| TPH25T2K(S)IC   | 5                   | 3Ø 230V     | 25                  | 28                     | 3"          | 3"           | 65                    | 118                    |
|                 |                     | 3Ø 460V     | 15                  |                        |             |              |                       |                        |
| TPH25T3K(S)IC   | 5                   | 3Ø 230V     | 25                  | 42                     | 3"          | 3"           | 98                    | 118                    |
|                 |                     | 3Ø 460V     | 15                  |                        |             |              |                       |                        |
| TPH25T4K(S)IC   | 7½                  | 3Ø 230V     | 50                  | 56                     | 3"          | 3"           | 130                   | 118                    |
|                 |                     | 3Ø 460V     | 20                  |                        |             |              |                       |                        |
| TPH25T5K(S)IC   | 10                  | 3Ø 230V     | 60                  | 70                     | 3"          | 3"           | 160                   | 118                    |
|                 |                     | 3Ø 460V     | 30                  |                        |             |              |                       |                        |
| TPH25T6K(S)IC   | 10                  | 3Ø 230V     | 60                  | 85                     | 3"          | 3"           | 196                   | 118                    |
|                 |                     | 3Ø 460V     | 30                  |                        |             |              |                       |                        |
| TPH50T2.5K(S)IC | 7½                  | 3Ø 230V     | 50                  | 35                     | 4"          | 4"           | 80                    | 214                    |
|                 |                     | 3Ø 460V     | 20                  |                        |             |              |                       |                        |
| TPH50T4K(S)IC   | 10                  | 3Ø 230V     | 60                  | 56                     | 4"          | 4"           | 130                   | 214                    |
|                 |                     | 3Ø 460V     | 30                  |                        |             |              |                       |                        |
| TPH50T5K(S)IC   | 15                  | 3Ø 230V     | 75                  | 70                     | 4"          | 4"           | 160                   | 214                    |
|                 |                     | 3Ø 460V     | 40                  |                        |             |              |                       |                        |

\*\* (S): Stainless steel series

## Dimensions (in.)

• Fig. 3 TPH 25T – IC

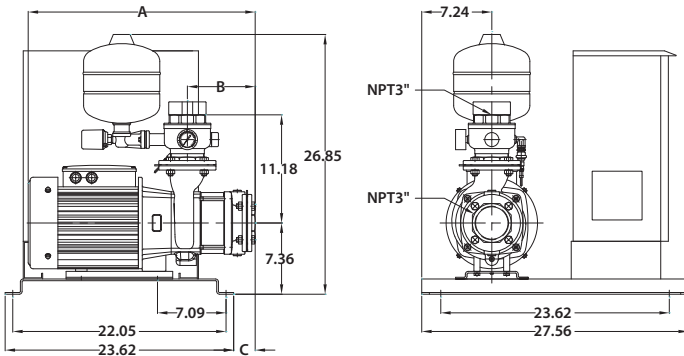

• Fig. 4 TPH 50T – IC

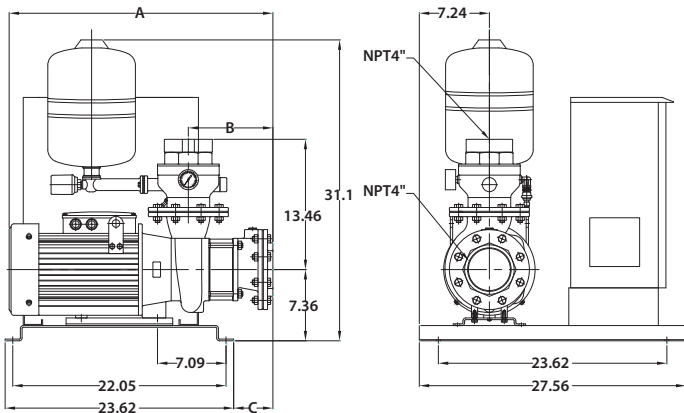

| Model        | A     | B    | C     | Pressure tank (gal) | Fig. | N.W. (lb) |
|--------------|-------|------|-------|---------------------|------|-----------|
| TPH25T2KIC   | 21.18 | 4.72 | -0.09 | 1.0                 | 3    | 213.6     |
| TPH25T3KIC   | 23.54 | 7.09 | 2.28  | 1.0                 | 3    | 226.4     |
| TPH25T4KIC   | 23.54 | 7.09 | 2.28  | 1.0                 | 3    | 227.1     |
| TPH25T5KIC   | 27.87 | 9.45 | 4.65  | 1.0                 | 3    | 253.1     |
| TPH25T6KIC   | 27.87 | 9.45 | 4.65  | 1.0                 | 3    | 253.5     |
| TPH50T2.5KIC | 22.95 | 6.38 | 1.69  | 3.17                | 4    | 254.4     |
| TPH50T4KIC   | 27.28 | 8.74 | 4.06  | 3.17                | 4    | 280.8     |
| TPH50T5KIC   | 29.25 | 8.74 | 4.06  | 3.17                | 4    | 308.0     |

# TPH 2T/4T ICx2

## Specifications - Duplex

| Model           | Inverter Controller |  | No-Fuse Breaker (A) | Pre-set Pressure (PSI) | Inlet (NPT) | Outlet (NPT) | Nominal Set Head (ft) | Nominal set Flow (GPM) |
|-----------------|---------------------|--|---------------------|------------------------|-------------|--------------|-----------------------|------------------------|
|                 | Output Power (HP)   | Voltage (V)                            |                     |                        |             |              |                       |                        |
| TPH2T3K(S)IC x2 | 1 x2                | 1Ø 115V / 1Ø 230V / 3Ø 230V<br>3Ø 460V | 30/ 15/ 10<br>5     | 42                     | 1"          | 1½"          | 98                    | 16                     |
| TPH2T4K(S)IC x2 | 1 x2                | 1Ø 115V / 1Ø 230V / 3Ø 230V<br>3Ø 460V | 30/ 15/ 10<br>5     | 56                     | 1"          | 1½"          | 130                   | 16                     |
| TPH2T5K(S)IC x2 | 1 x2                | 1Ø 115V / 1Ø 230V / 3Ø 230V<br>3Ø 460V | 50/ 30/ 15<br>10    | 70                     | 1"          | 1½"          | 160                   | 16                     |
| TPH2T6K(S)IC x2 | 1 x2                | 1Ø 115V / 1Ø 230V / 3Ø 230V<br>3Ø 460V | 50/ 30/ 15<br>10    | 85                     | 1"          | 1½"          | 196                   | 16                     |
| TPH4T2K(S)IC x2 | 1 x2                | 1Ø 115V / 1Ø 230V / 3Ø 230V<br>3Ø 460V | 30/ 15/ 10<br>5     | 28                     | 1½"         | 2"           | 65                    | 32                     |
| TPH4T3K(S)IC x2 | 1 x2                | 1Ø 115V / 1Ø 230V / 3Ø 230V<br>3Ø 460V | 50/ 30/ 15<br>10    | 42                     | 1½"         | 2"           | 98                    | 32                     |
| TPH4T4K(S)IC x2 | 2 x2                | 1Ø 230V / 3Ø 230V<br>3Ø 460V           | 30/ 15<br>10        | 56                     | 1½"         | 2"           | 130                   | 32                     |
| TPH4T5K(S)IC x2 | 2 x2                | 1Ø 230V / 3Ø 230V<br>3Ø 460V           | 40/ 30<br>15        | 70                     | 1½"         | 2"           | 160                   | 32                     |
| TPH4T6K(S)IC x2 | 2 x2                | 1Ø 230V / 3Ø 230V<br>3Ø 460V           | 40/ 40<br>20        | 85                     | 1½"         | 2"           | 196                   | 32                     |

\*\* (S): Stainless steel series

## Dimensions ( in.)

• Fig. 5 TPH 2T / 4T – IC x2

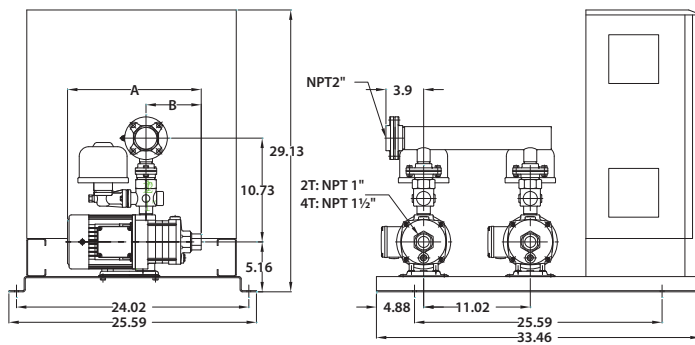

| Model        | A     | B    | Pressure tank (gal) | Fig. | N.W. (lb) |
|--------------|-------|------|---------------------|------|-----------|
| TPH2T3KIC x2 | 12.72 | 4.61 | 0.2 x2              | 5    | 211.2     |
| TPH2T4KIC x2 | 13.43 | 5.31 | 0.2 x2              | 5    | 211.6     |
| TPH2T5KIC x2 | 15.71 | 6.02 | 0.2 x2              | 5    | 218.2     |
| TPH2T6KIC x2 | 16.42 | 6.73 | 0.2 x2              | 5    | 218.7     |
| TPH4T2KIC x2 | 13.50 | 5.39 | 0.2 x2              | 5    | 210.3     |
| TPH4T3KIC x2 | 16.10 | 6.42 | 0.2 x2              | 5    | 217.4     |
| TPH4T4KIC x2 | 17.17 | 7.48 | 0.2 x2              | 5    | 220.9     |
| TPH4T5KIC x2 | 18.23 | 8.54 | 0.2 x2              | 5    | 221.3     |
| TPH4T6KIC x2 | 20.51 | 9.65 | 0.2 x2              | 5    | 229.7     |



## Specifications - Duplex

| Model            | Inverter Controller |                             | No-Fuse Breaker (A) | Pre-set Pressure (PSI) | Inlet (NPT) | Outlet (NPT) | Nominal Set Head (ft) | Nominal set Flow (GPM) |
|------------------|---------------------|-----------------------------|---------------------|------------------------|-------------|--------------|-----------------------|------------------------|
|                  | Output Power (HP)   | Voltage (V)                 |                     |                        |             |              |                       |                        |
| TPH 8T2K(S)IC x2 | 1 x2                | 1Ø 115V / 1Ø 230V / 3Ø 230V | 50/ 30/ 15          | 28                     | 2"          | 3"           | 65                    | 68                     |
|                  |                     | 3Ø 460V                     | 10                  |                        |             |              |                       |                        |
| TPH8T3K(S)IC x2  | 2 x2                | 1Ø 230V / 3Ø 230V           | 40/ 30              | 42                     | 2"          | 3"           | 98                    | 68                     |
|                  |                     | 3Ø 460V                     | 15                  |                        |             |              |                       |                        |
| TPH8T4K(S)IC x2  | 3 x2                | 1Ø 230V / 3Ø 230V           | 50/ 40              | 56                     | 2"          | 3"           | 130                   | 68                     |
|                  |                     | 3Ø 460V                     | 15                  |                        |             |              |                       |                        |
| TPH8T5K(S)IC x2  | 3 x2                | 1Ø 230V / 3Ø 230V           | 60/ 40              | 70                     | 2"          | 3"           | 160                   | 60                     |
|                  |                     | 3Ø 460V                     | 15                  |                        |             |              |                       |                        |
| TPH12T2K(S)IC x2 | 2 x2                | 1Ø 230V / 3Ø 230V           | 15/ 10              | 28                     | 2"          | 3"           | 65                    | 120                    |
|                  |                     | 3Ø 460V                     | 5                   |                        |             |              |                       |                        |
| TPH12T3K(S)IC x2 | 3 x2                | 1Ø 230V / 3Ø 230V           | 50/ 40              | 42                     | 2"          | 3"           | 98                    | 120                    |
|                  |                     | 3Ø 460V                     | 15                  |                        |             |              |                       |                        |
| TPH12T4K(S)IC x2 | 5 x2                | 3Ø 230V                     | 40                  | 56                     | 2"          | 3"           | 130                   | 120                    |
|                  |                     | 3Ø 460V                     | 20                  |                        |             |              |                       |                        |
| TPH12T5K(S)IC x2 | 5 x2                | 3Ø 230V                     | 50                  | 70                     | 2"          | 3"           | 160                   | 120                    |
|                  |                     | 3Ø 460V                     | 30                  |                        |             |              |                       |                        |

\*\* (S): Stainless steel series

## Dimensions ( in.)

• Fig. 6 TPH 8T / 12T – IC x2

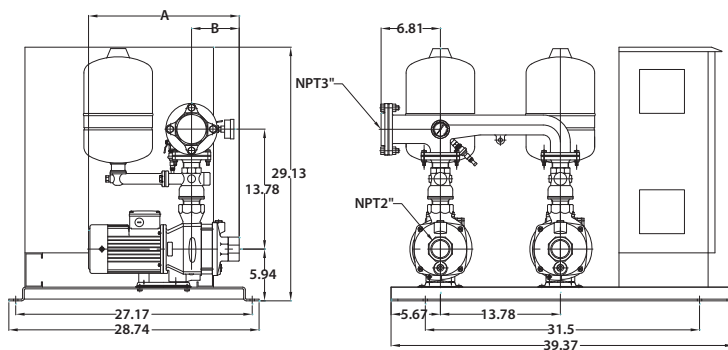

| Model         | A     | B    | Pressure tank (gal) | Fig. | N.W. (lb) |
|---------------|-------|------|---------------------|------|-----------|
| TPH8T2KIC x2  | 17.24 | 4.21 | 3.17 x2             | 6    | 259.3     |
| TPH8T3KIC x2  | 18.50 | 5.47 | 3.17 x2             | 6    | 264.5     |
| TPH8T4KIC x2  | 18.50 | 5.47 | 3.17 x2             | 6    | 288.4     |
| TPH8T5KIC x2  | 19.84 | 6.81 | 3.17 x2             | 6    | 300.4     |
| TPH12T2KIC x2 | 17.24 | 4.21 | 3.17 x2             | 6    | 264.5     |
| TPH12T3KIC x2 | 18.50 | 5.47 | 3.17 x2             | 6    | 288.4     |
| TPH12T4KIC x2 | 18.50 | 5.47 | 3.17 x2             | 6    | 317.5     |
| TPH12T5KIC x2 | 19.84 | 6.81 | 3.17x2              | 6    | 347.7     |

# TPH 25T ICx2

## Specifications - Duplex

| Model            | Inverter Controller |             | No-Fuse Breaker (A) | Pre-set Pressure (PSI) | Inlet (NPT) | Outlet (NPT) | Nominal Set Head (ft) | Nominal set Flow (GPM) |
|------------------|---------------------|-------------|---------------------|------------------------|-------------|--------------|-----------------------|------------------------|
|                  | Output Power (HP)   | Voltage (V) |                     |                        |             |              |                       |                        |
| TPH25T2K(S)IC x2 | 5 x2                | 3Ø 230V     | 50                  | 28                     | 3"          | 4"           | 65                    | 236                    |
|                  |                     | 3Ø 460V     | 30                  |                        |             |              |                       |                        |
| TPH25T3K(S)IC x2 | 5 x2                | 3Ø 230V     | 50                  | 42                     | 3"          | 4"           | 98                    | 236                    |
|                  |                     | 3Ø 460V     | 30                  |                        |             |              |                       |                        |
| TPH25T4K(S)IC x2 | 7½ x2               | 3Ø 230V     | 100                 | 56                     | 3"          | 4"           | 130                   | 236                    |
|                  |                     | 3Ø 460V     | 40                  |                        |             |              |                       |                        |
| TPH25T5K(S)IC x2 | 10 x2               | 3Ø 230V     | 125                 | 70                     | 3"          | 4"           | 160                   | 236                    |
|                  |                     | 3Ø 460V     | 60                  |                        |             |              |                       |                        |
| TPH25T6K(S)IC x2 | 10 x2               | 3Ø 230V     | 125                 | 85                     | 3"          | 4"           | 196                   | 236                    |
|                  |                     | 3Ø 460V     | 60                  |                        |             |              |                       |                        |

\*\* (S): Stainless steel series

## Dimensions (in.)

• Fig. 7 TPH 25T2K-3KIC x2

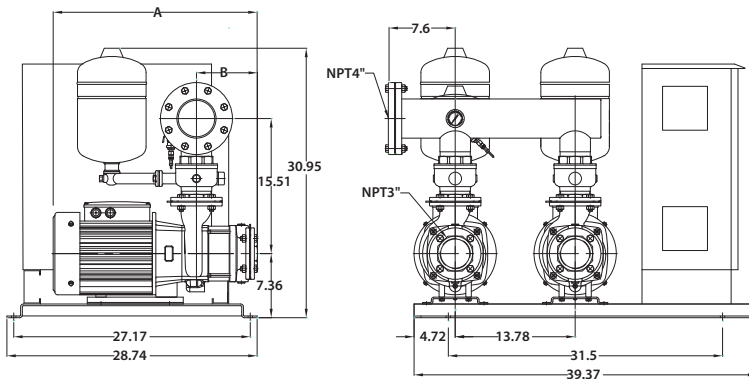

| Model         | A     | B    | Pressure tank (gal) | Fig. | N.W. (lb) |
|---------------|-------|------|---------------------|------|-----------|
| TPH25T2KIC x2 | 21.18 | 4.72 | 3.17 x2             | 7    | 467.4     |
| TPH25T3KIC x2 | 23.54 | 7.09 | 3.17 x2             | 7    | 492.9     |
| TPH25T4KIC x2 | 23.54 | 7.09 | 3.17 x2             | 8    | 493.8     |
| TPH25T5KIC x2 | 27.87 | 9.45 | 3.17 x2             | 8    | 556.9     |
| TPH25T6KIC x2 | 27.87 | 9.45 | 3.17 x2             | 8    | 557.8     |

• Fig. 8 TPH 25T4-6K IC x2

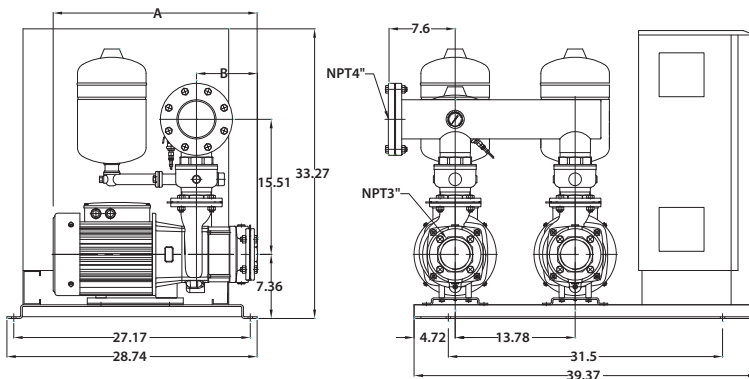

## Specifications - Duplex

| Model              | Inverter Controller |             | No-Fuse Breaker (A) | Pre-set Pressure (PSI) | Inlet (NPT) | Outlet (NPT) | Nominal Set Head (ft) | Nominal set Flow (GPM) |
|--------------------|---------------------|-------------|---------------------|------------------------|-------------|--------------|-----------------------|------------------------|
|                    | Output Power (HP)   | Voltage (V) |                     |                        |             |              |                       |                        |
| TPH50T2.5K(S)IC x2 | 7½ x2               | 3Ø 230V     | 100                 | 35                     | 4"          | 6"           | 80                    | 428                    |
|                    |                     | 3Ø 460V     | 40                  |                        |             |              |                       |                        |
| TPH50T4K(S)IC x2   | 10 x2               | 3Ø 230V     | 125                 | 56                     | 4"          | 6"           | 130                   | 428                    |
|                    |                     | 3Ø 460V     | 60                  |                        |             |              |                       |                        |
| TPH50T5K(S)IC x2   | 15 x2               | 3Ø 230V     | 125                 | 70                     | 4"          | 6"           | 160                   | 428                    |
|                    |                     | 3Ø 460V     | 75                  |                        |             |              |                       |                        |

\*\* (S): Stainless steel series

## Dimensions ( in.)

• Fig. 9 TPH 50T – IC x2

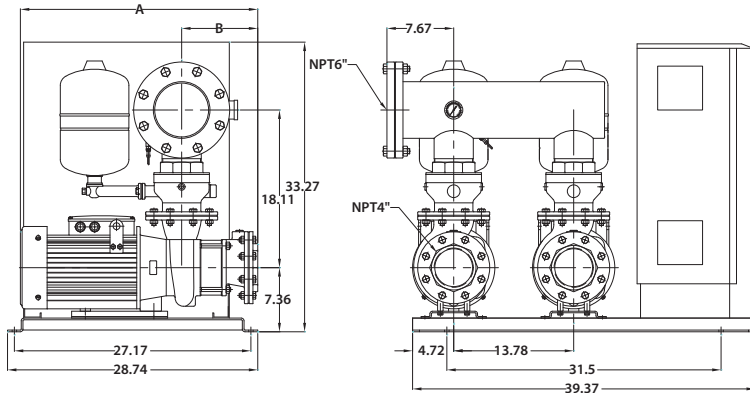

| Model           | A     | B    | Pressure tank (gal) | Fig. | N.W. (lb) |
|-----------------|-------|------|---------------------|------|-----------|
| TPH50T2.5KIC x2 | 22.95 | 6.38 | 3.17 x2             | 9    | 547.2     |
| TPH50T4KIC x2   | 27.28 | 8.74 | 3.17 x2             | 9    | 644.2     |
| TPH50T5KIC x2   | 29.25 | 8.74 | 3.17 x2             | 9    | 684.3     |